



## Request for Quotation #033720 - Attachments

Including:

Site Map

Curing Room & Lab Improvements Bldg. 4

Curing Room Improvements Bldg.4

Office Room Improvements Bldg. 4

Sampling Room Improvements Bldg. 8

# Riverside County Flood Control & Water Conservation District

## SITE MAP

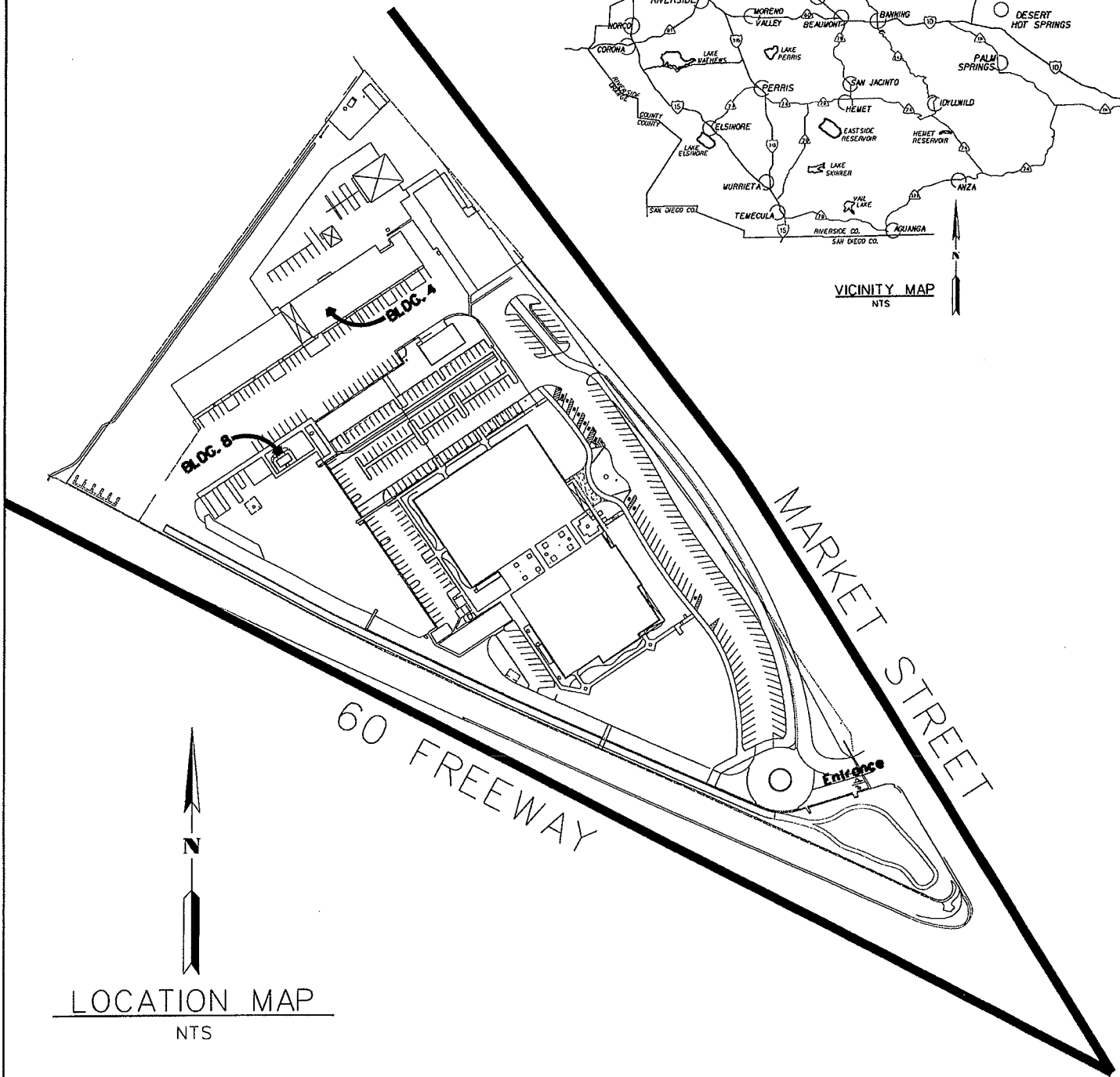
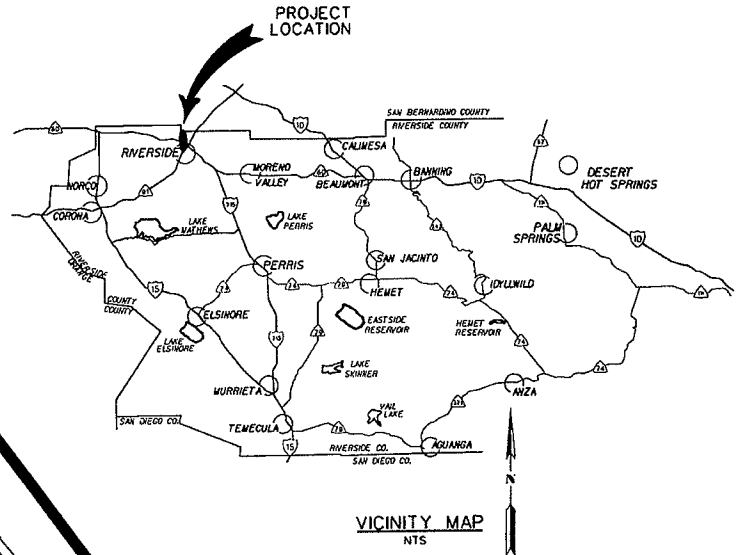

LOCATION MAP  
NTS

# CURING ROOM & LAB IMPROVEMENTS BLDG 4

OFFICE  
SEE PAGE 3

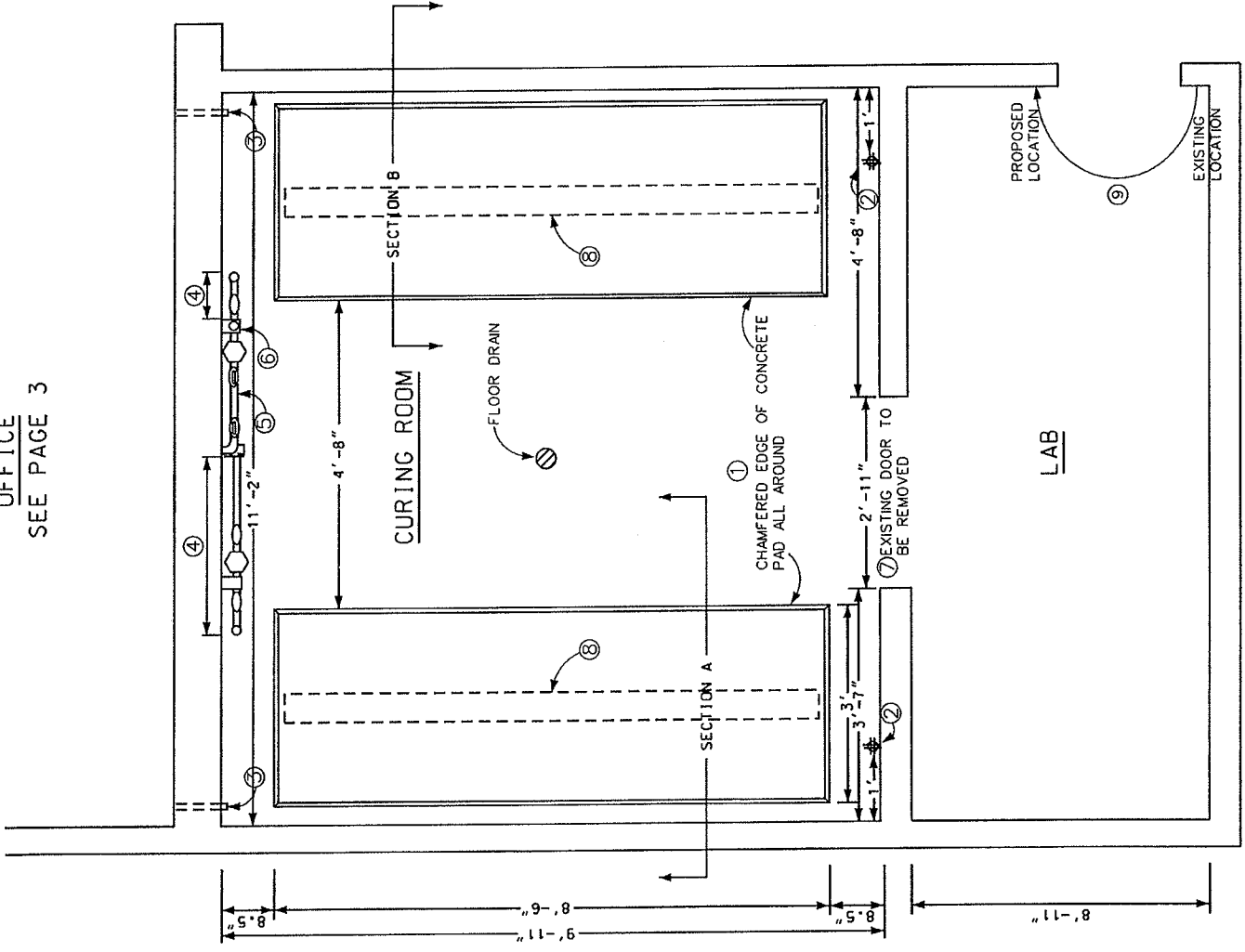

GENERAL NOTES

CURING ROOM ONLY  
REMOVE EXPOSED PLUMBING, WALL AND CEILING COVERING WHICH CONSISTS OF TONGUE AND GROOVE PLANKS AND MOISTURE BARRIER VISQUEEN UNDERNEATH EXISTING DOOR, DOOR FRAME, AND HARDWARE.

CURING ROOM ONLY  
INSTALL WATER PROOF INSULATION ON ALL WALL AND CEILING SURFACES. INSTALL NEW MOISTURE RESISTANT CEMENT BOARD WITH FRP COVERING ON WALLS AND CEILING.

CURING ROOM & LAB  
SCRUB FLOOR CLEAN AND APPLY A CEMENTITIOUS URETHANE SEALER AND/OR APPROVED EQUAL WITH SLIP RESISTANT TEXTURE TO ENTIRE FLOOR SURFACE, INCLUDING CONCRETE PAD AND 4 INCHES UP WALLS. FLOOR SEALER TO BE APPROVED BY DISTRICT ENGINEER.

PLAN NOTES

- ① INSTALL CONCRETE PAD TO DIMENSIONS SHOWN ON PLAN.
- ② INSTALL FOURPLEX RECEPTACLE, 110V-20A.
- ③ INSTALL 3/4" ELECTRICAL CONDUIT TERMINATE IN A JUNCTION BOX.
- ④ REMOVE EXISTING SHUTOFF VALVE AND WATER FILTER.
- ⑤ REMOVE EXISTING SHUTOFF VALVE AND WATER FILTER AND REINSTALL SHUTOFF VALVE AND WATER FILTER AFTER RECONSTRUCTION OF WALL.
- ⑥ INSTALL NEW HOSE BIB AND HOSE REEL. LOCATION TO BE APPROVED BY DISTRICT ENGINEER.
- ⑦ REMOVE EXISTING DOOR.
- ⑧ INSTALL WET LOCATION 8' FLORESCENT OVERHEAD LIGHTING.
- ⑨ RELOCATE EXISTING LIGHT SWITCH.

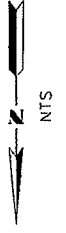

# CURING ROOM IMPROVEMENTS

## BLDG 4

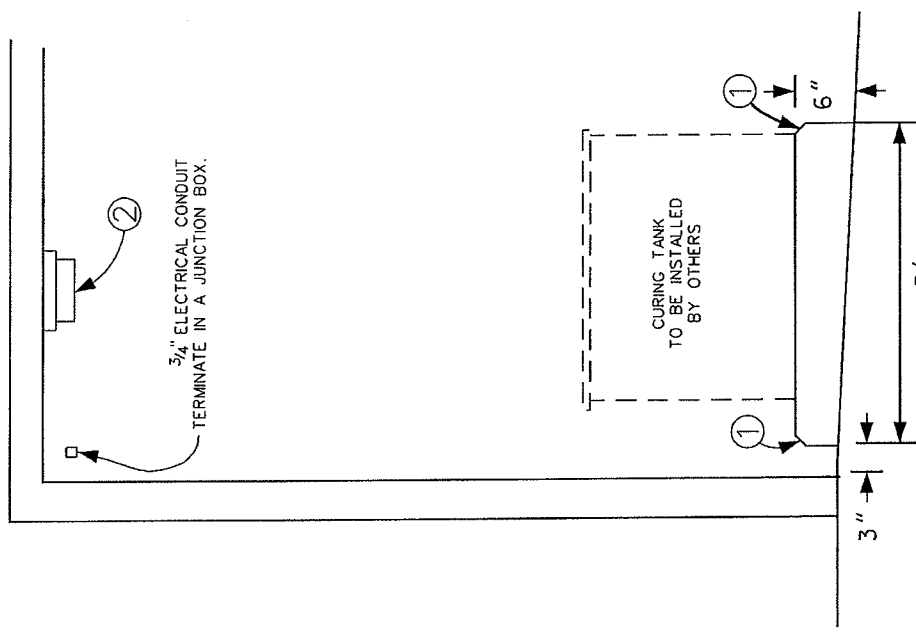
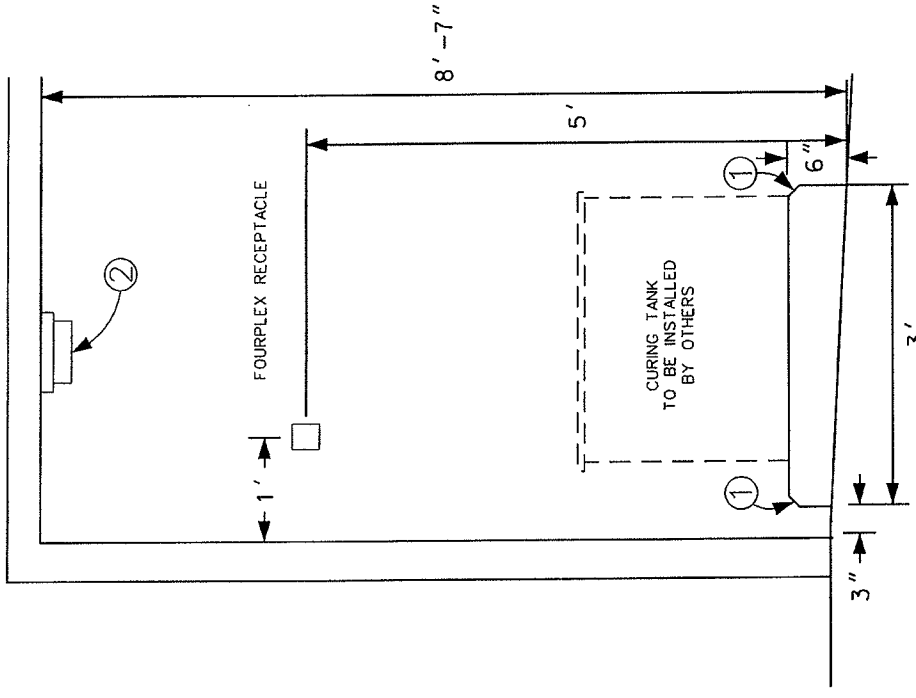

SECTION B

SECTION A

- PLAN NOTES
- ① CHAMFERED EDGE OF CONCRETE SLAB ALL AROUND.
  - ② INSTALL TWO WET LOCATION 8' OVERHEAD FLORESCENT LIGHTING.

# OFFICE ROOM IMPROVEMENTS BLDG 4

8'-11"

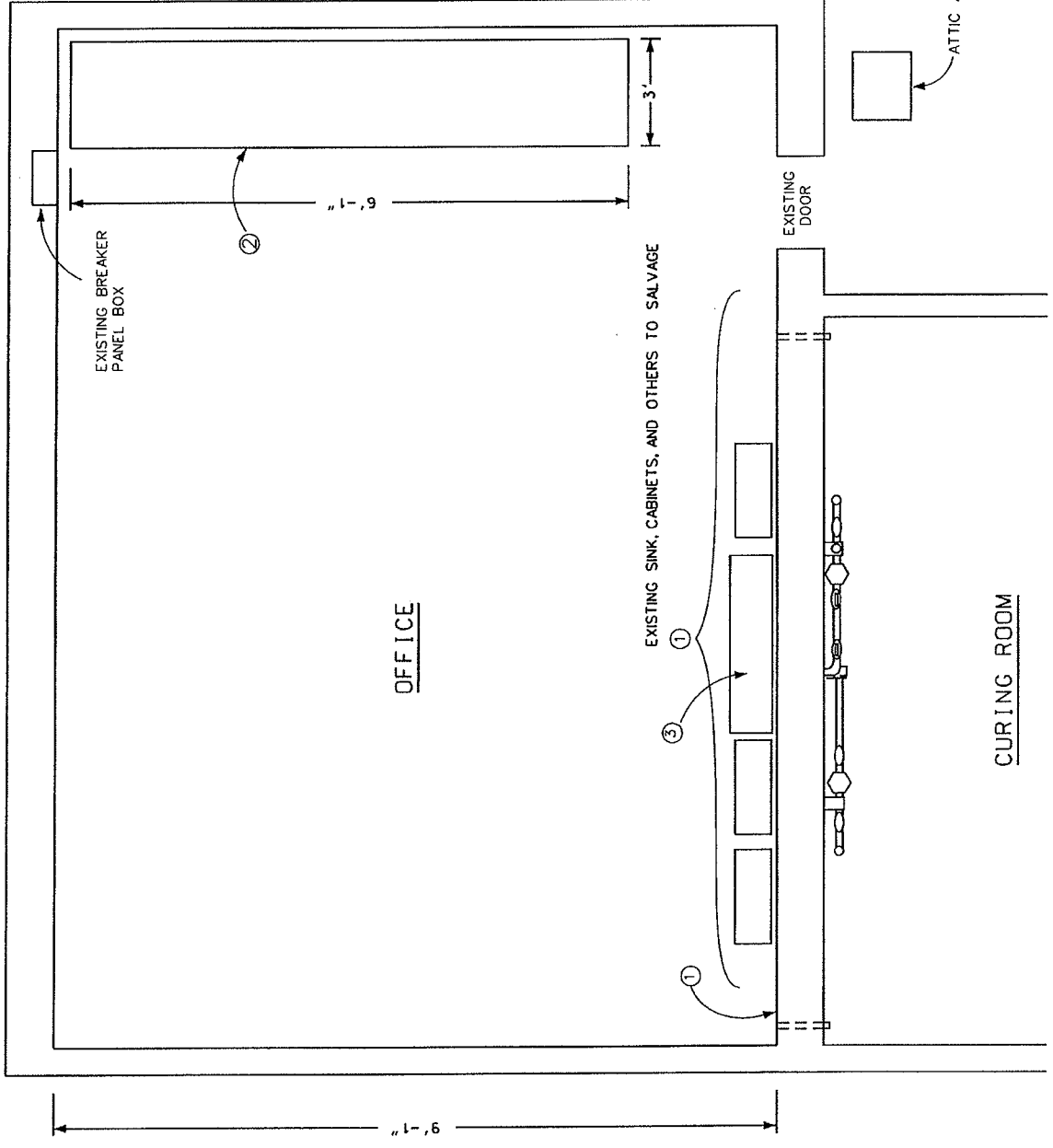

GENERAL NOTES

ADD BREAKER FOR NEW FOURPLEX RECEPTACLES IN CURING ROOM. (SEE PAGE 1)

PLAN NOTES

- ① REMOVE EXISTING WALL AND INSTALL NEW WALL TO CONCEAL EXISTING UTILITIES. SALVAGE ALL EXISTING CABINETS, SINKS AND FIXTURES ALONG WALL.
- ② REMOVE AND REPLACE WITH LAMINATE WORK SURFACE PER THE DISTRICT ENGINEER'S DIRECTION. MATCH DIMENSIONS SHOWN ON PLANS.
- ③ RE-MOUNT EXISTING SINK AGAINST WALL AND RE-INSTALL OLD FAUCET AND FIXTURES. INSTALL HOT & COLD SHUTOFF VALVES UNDER SINK.

OFFICE

EXISTING SINK, CABINETS, AND OTHERS TO SALVAGE

EXISTING DOOR

ATTIC ACCESS

CURING ROOM

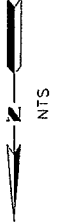

# SAMPLING ROOM IMPROVEMENTS

## BLDG 8

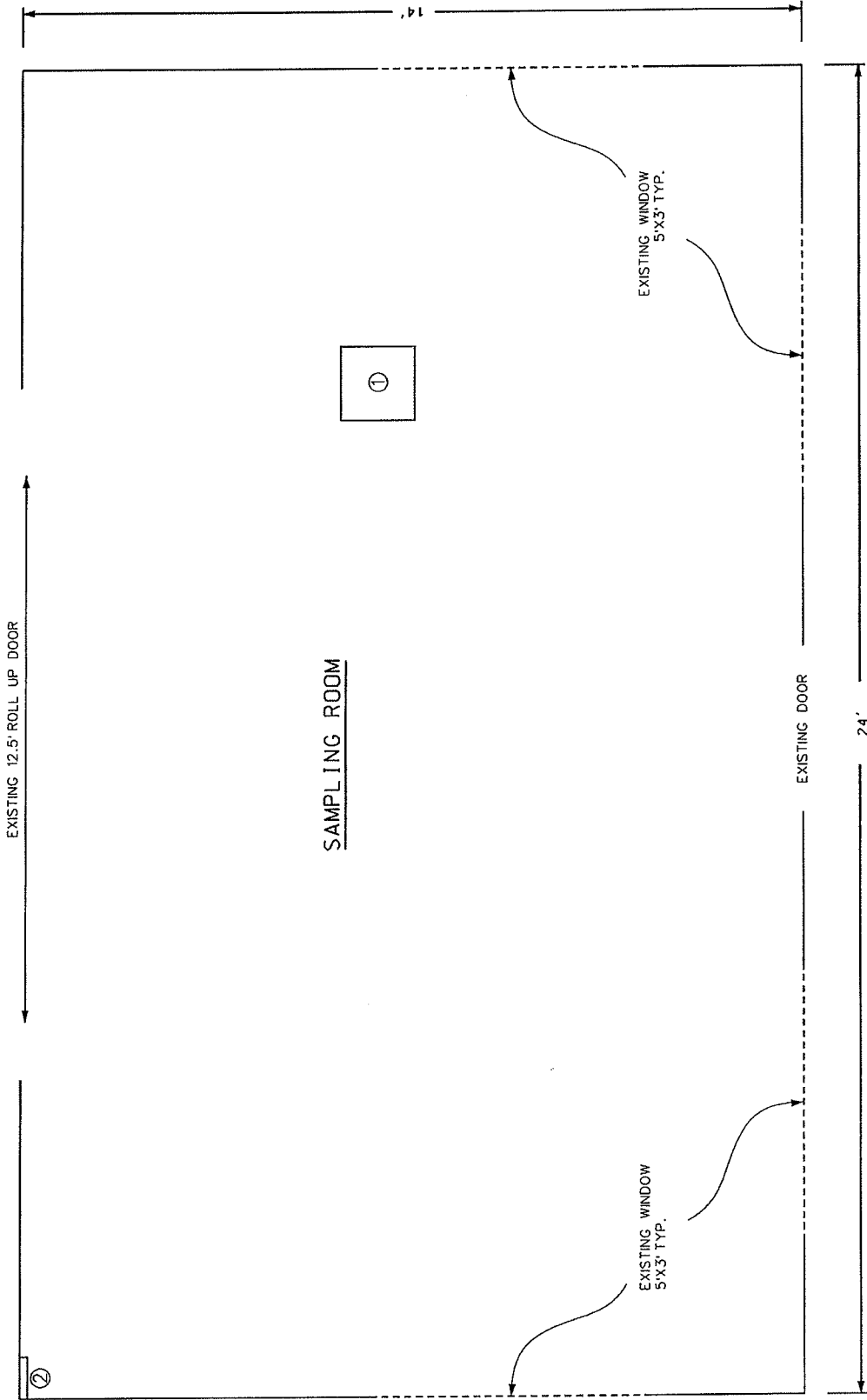

**GENERAL NOTES**

INSTALL WATER PROOF INSULATION ON ALL SURFACES. INSTALL NEW MOISTURE RESISTANT CEMENT BOARD WITH FRP COVERING ON WALLS AND CEILING.

SCRUB FLOOR CLEAN AND APPLY A CEMENTITIOUS URETHANE SEALER AND/OR APPROVED EQUAL WITH SLIP RESISTANT TEXTURE TO ENTIRE FLOOR SURFACE AND 4 INCHES UP WALLS. FLOOR SEALER TO BE APPROVED BY DISTRICT ENGINEER.

**PLAN NOTES**

① PROVIDE 16"X16" CAVITY IN CEILING AND INSTALL ROOF VENT/WIND TURBINE. POSITION TO BE APPROVED BY DISTRICT ENGINEER.

② INSTALL ACCESS PANEL DOOR TO EXISTING WATERLINE STUB OUT.

