

**RIVERSIDE COUNTY FLOOD CONTROL
AND WATER CONSERVATION DISTRICT**

PUBLIC NOTICE

The Riverside County Flood Control and Water Conservation District (District) announces the availability of approximately 30,000 cubic yards of excess earth material within District right-of-way for the Proposed Murrieta Creek Basin located west of Jefferson Avenue (between Winchester Road & Oak Avenue) within the city of Temecula, Riverside County, California. An Encroachment Permit (EP) will be issued to the awarded applicant. The EP will be subject to the adherence of mandatory terms and conditions which includes, but is not limited to the following:

1. Comply with all applicable requirements of the EP information sheet (copies available at the District's office and in the District's website: <http://rcflood.org/EncroachmentPermits.aspx>).
2. Comply with all applicable provisions of the South Coast Air Quality Management District's fugitive dust rule 403 (www.aqmd.gov/docs/default-source/rule-book/rule-iv/rule-403.pdf?sfvvsn=4) and all the applicable conditions of the District's environmental regulatory approvals and permits.
3. Securing all legally required clearances and permits, including but not limited to air quality and regulatory permits, haul permits, grading permits and any other required permits authorizing the legal offsite disposal of the material.
4. Submittal of a work plan subject to the District's approval. Excavation beyond the District's approved project limits is prohibited. Screening operation will be authorized only on a case by case basis.
5. Furnishing proof of insurance acceptable to the District.
6. Deposit of either cash or a District approved letter of credit in the amount of \$10,000 in advance of any work to ensure that upon completion of the material removal, the worksite is left in a manner acceptable to the District.
7. Submit a copy of the haul route approved by the Transportation Department to the District prior to beginning work. Haul routes must be kept clean of sediment and debris. Working hours for the operation shall be from the 7:00 a.m. to the 4:30 p.m. and no work will be allowed on weekends or County Holidays.
8. Payment of the District's standard EP filing fee in effect at the time of application and payment of all District costs incurred in administering the EP, including inspection costs and royalty fees (including 3% MSHCP fees) on a monthly basis. Also included is a cultural resource monitoring fee for the full duration of the sediment removal activities (approx. \$60/hr & \$90/hr for OT).
9. The cost of a Nesting Bird Survey and monitoring will be borne by the applicant.
10. Proposal price per cubic yard excavated shall be paid to the District.
11. Applications must also include an estimated desired quantity, rate of removal, and start/end dates, using the attached Sediment Removal Proposal Form.
12. The District makes no guarantee as to the actual quantities available or the quality of the material.

All material removal will be subject to compliance with the California Environmental Quality Act (CEQA). Required CEQA documentation and notifications will be completed by the District.

The District reserves the right to issue or to refuse to issue such EP in the sole and exclusive exercise of its discretion, and to terminate and withdraw the opportunity to obtain such permits at any time. Once issued however, any such permit will not be withdrawn or terminated except upon good cause.

Proposals shall be submitted to the following:

Riverside County Flood Control and Water Conservation District
1995 Market Street
Riverside, CA 92501
Attention: Rick Landeros
Regarding: Proposed Murrieta Creek Basin

Additional information may be obtained by calling Rick Landeros at 951.955.8323 or Komy Ghods at 951.955.1210.

**RIVERSIDE COUNTY FLOOD CONTROL
AND WATER CONSERVATION DISTRICT**

SEDIMENT REMOVAL PROPOSAL FORM

PROPOSED MURRIETA CREEK BASIN – SEDIMENT REMOVAL

Name: _____

Company: _____

Address: _____

Telephone: _____

Email: _____

Estimated duration of sediment removal operation: _____ working days

Rate of removal (cy/day) _____

Proposal Amount: \$ _____

Applicant agrees to do the work in accordance with all pertinent District rules and regulations and that the proposed work as shown in the attached drawings will be subject to inspection and approval. (Upon approval the applicant must refer to the Encroachment Permit Information Sheet for details on the complete submittal required)

Signature

Date

FORM MUST BE SUBMITTED TO THE DISTRICT, OR EMAILED TO:

Rick Landeros
951.955.8323
ralander@rivco.org

RIVERSIDE COUNTY FLOOD CONTROL AND WATER CONSERVATION DISTRICT

TOTAL SEDIMENT TO BE REMOVED: APPROX. 30,000 CY

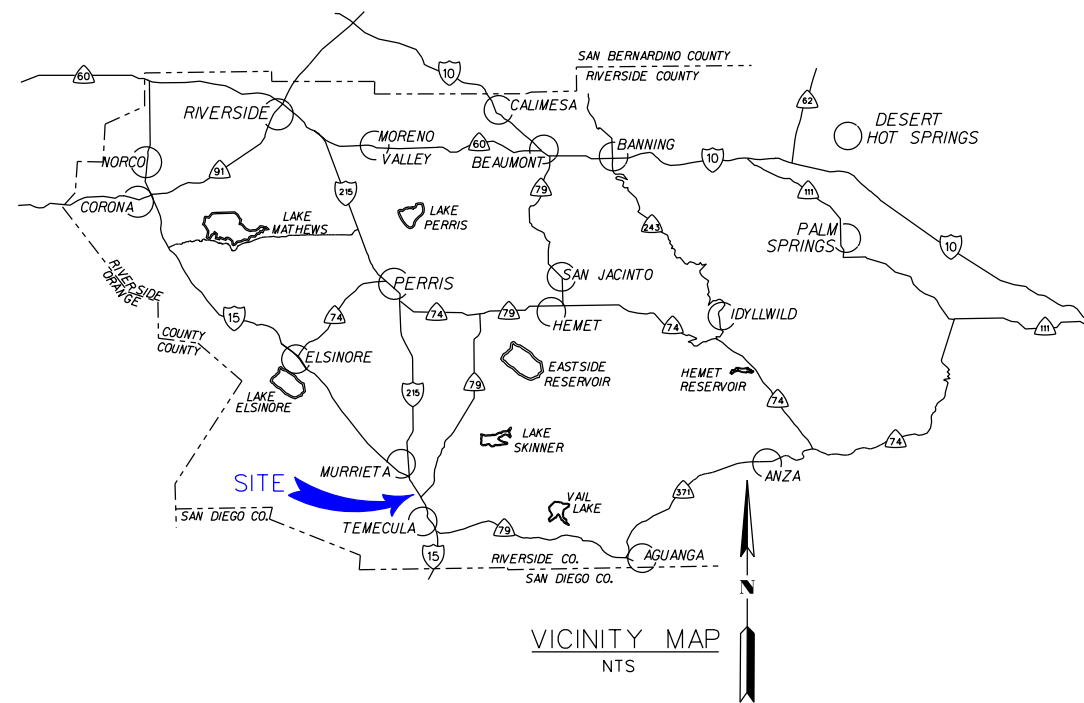
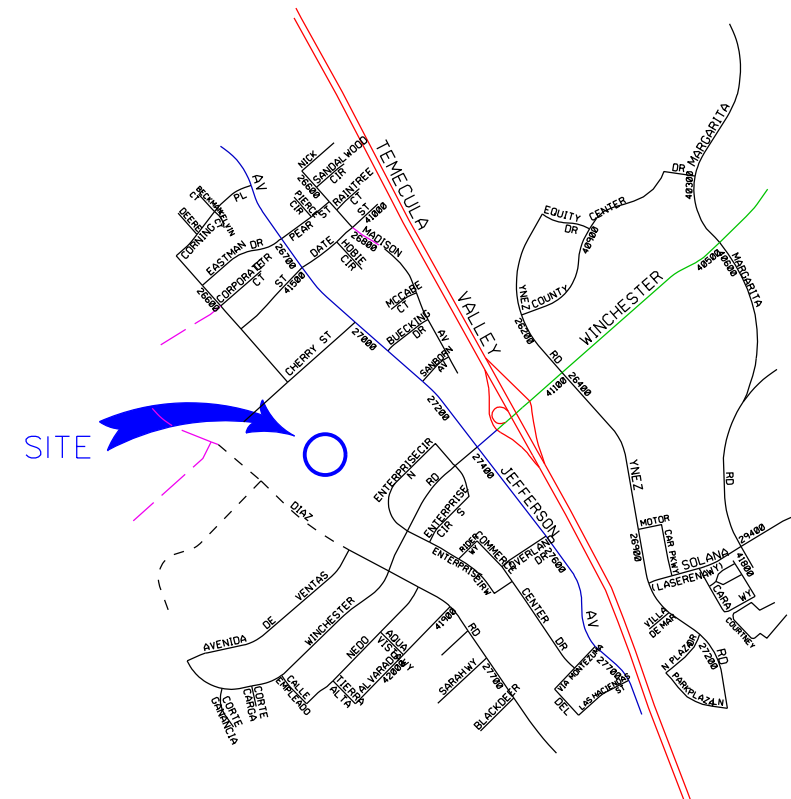

RIVERSIDE COUNTY FLOOD CONTROL AND WATER CONSERVATION DISTRICT	
MURRIETA CREEK BASIN SEDIMENT REMOVAL 2017	PROJECT NO. 7-0-00020