

Landscape improvements for the District headquarters - December 2007 update

RCB and Sons, Inc. of Riverside has developed and delivered the base site plan for the District landscape upgrades. Shown here are the "first-cut" construction and planting plans (2 sheets each). These ideas are very conceptual and will be further refined as staff works with the landscape architect.

Construction Plan

The construction plan will include upgrades to improve aesthetics, and to provide a driveway approach and parking access that easily identifies the Building 1A front lobby entrance, especially for visitors and persons conducting business with the District. Key aspects of the construction plan are:

- a preliminary footprint of the pedestrian walking path around the site perimeter.
- amenities such as a trellis, decorative fountain, benches, gazebo, tables and drinking fountains in the front lawn area adjacent to Building 1.
- a redesign of the front driveway entrance and parking lot, and water quality treatment features such as porous pavement in the parking area between Building 1A and the maintenance trailer. These improvements will undergo design generally from January to April 2008 and are not currently shown on the draft landscape plan sheets. The driveway entrance modification will likely involve replacing the current median and trees.
- a fence or wall along the Market Street border in the location of the present the chain-link fence.

Santa Ana River

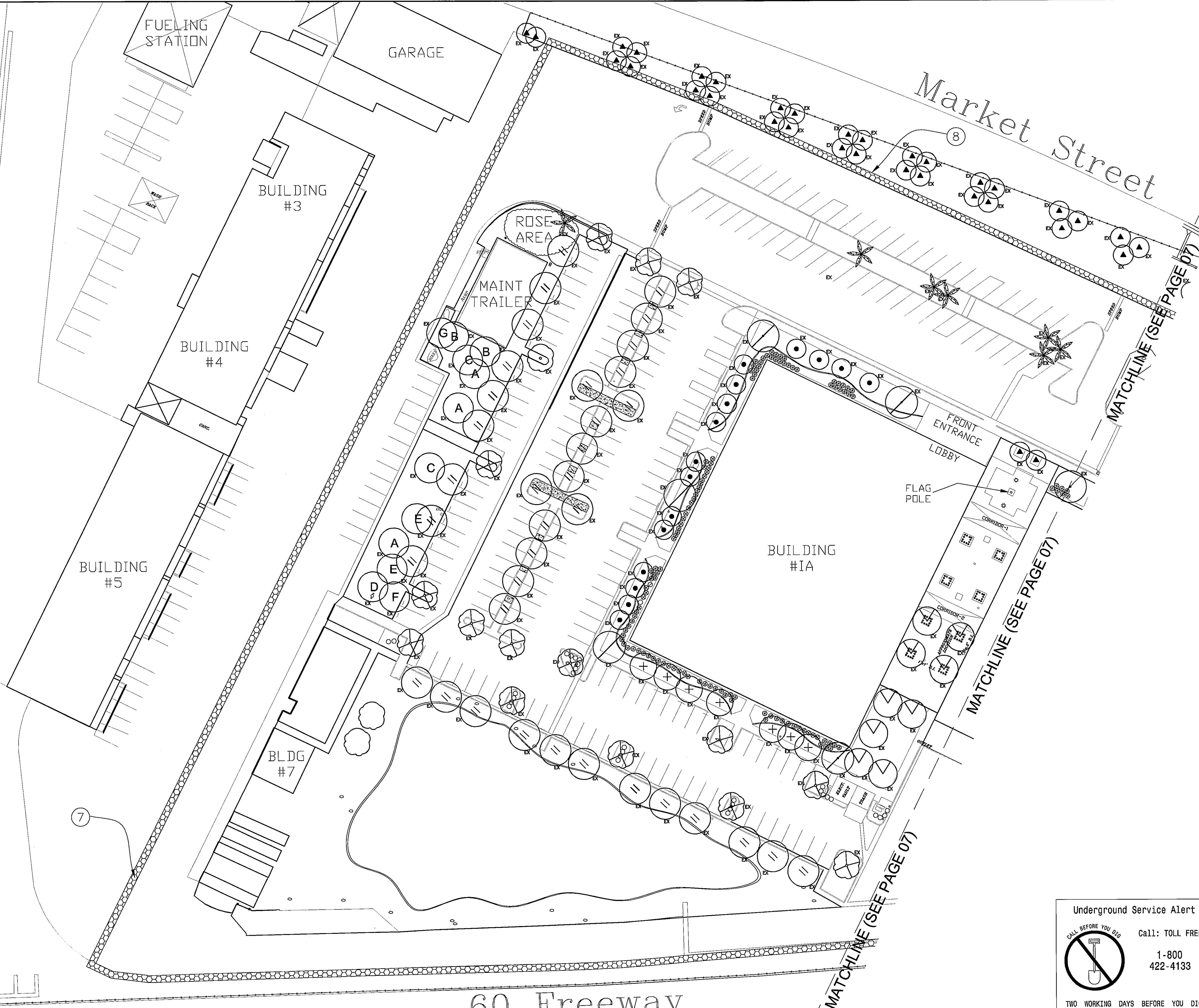

60 Freeway

Market Street

Underground Service Alert
 CALL BEFORE YOU DIG
 Call: TOLL FREE
 1-800-422-4133
 TWO WORKING DAYS BEFORE YOU DIG

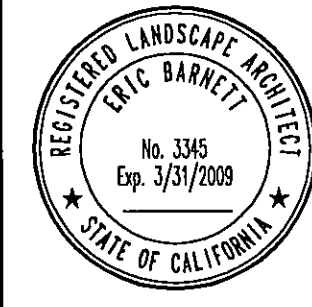

DATE	REVISION

CONSTRUCTION PLAN
 RIVERSIDE COUNTY FLOOD CONTROL AND
 WATER CONSERVATION DISTRICT
 1995 MARKET STREET
 RIVERSIDE, CALIFORNIA 92501

SCALE: 1" = 30'-0"
 SHEET NO. **6**
 OF **15**

RCB & SONS INC.
 11697 Magnolia Avenue
 Riverside, California 92503-4919
 Voice: (951) 689-6377
 Fax: (951) 689-4069
 Web Site: www.rcbandsons.com

Landscape Architect
 License No. 3345

Landscape Contractor
 License No. 349815

DATE: AUGUST 22, 2007

RCB & Sons
 LANDSCAPE ARCHITECT
 LANDSCAPE CONTRACTOR

DESIGNED: ERIC BARNETT
 DRAWN: S. HART

RCB & SONS, INC. LANDSCAPE ARCHITECT RESERVES THE COMMON LAW COPYRIGHT TO THE CONTENT AND USE OF THESE DRAWINGS OR PLANS, AND PORTION OF THESE DRAWINGS ARE TO BE REPRODUCED, CHANGED, OR COPIED WITHOUT THE EXPRESS WRITTEN PERMISSION OF RCB & SONS, INC. LANDSCAPE ARCHITECT.

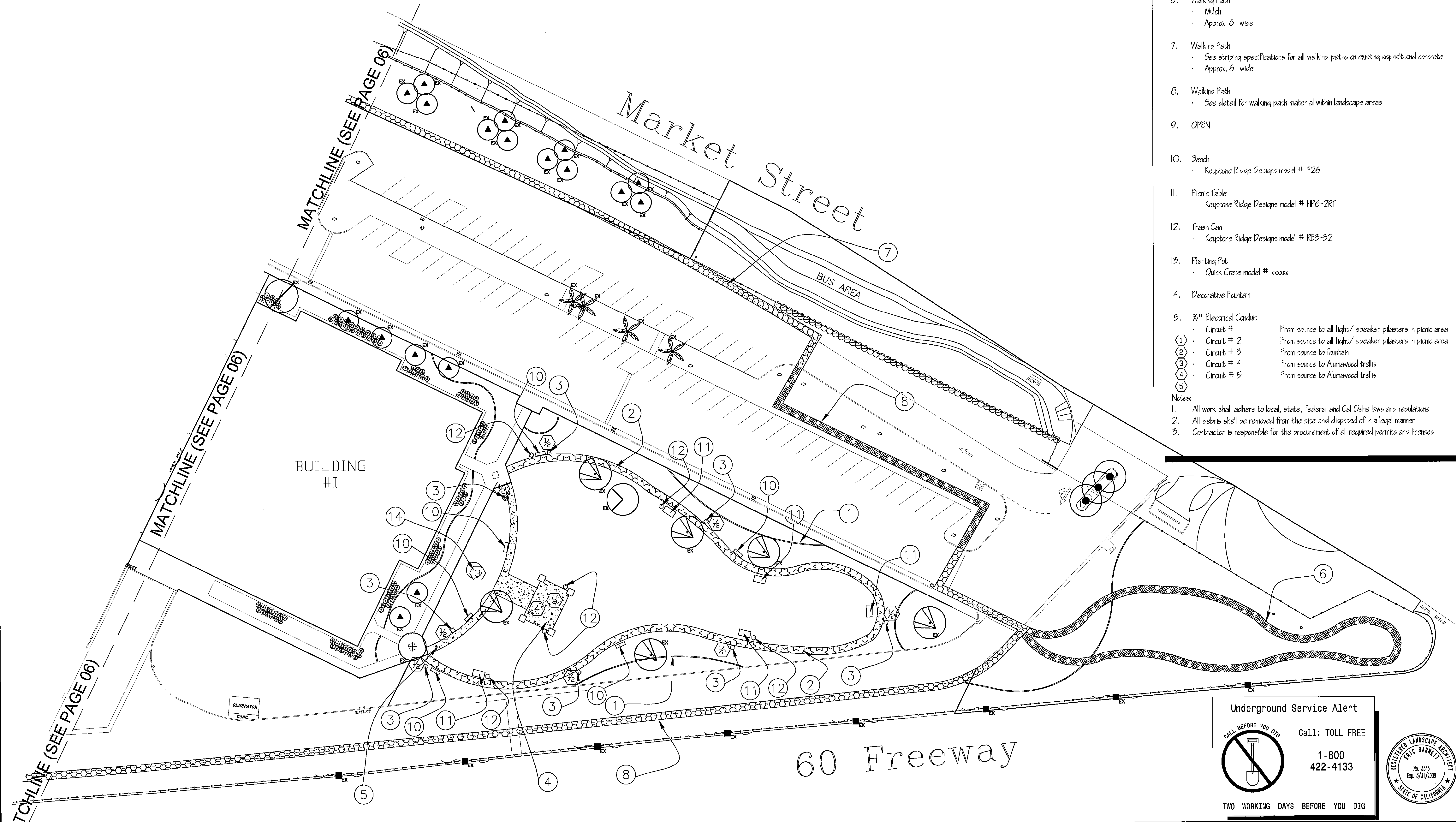

- CONSTRUCTION LEGEND**
- Concrete Moncurb
 - 6" x 6" concrete Moncurb
 - See detail
 - Decomposed Granite Path
 - 3' wide, 3" deep decomposed granite path
 - See detail
 - Light Plaster & Speaker
 - See detail
 - Alumawood Trellis
 - By Patio and Stuff
 - See detail and specifications
 - Concrete
 - 4" thick @ 2500 minimum PSI
 - Color: Tan
 - Walking Path
 - Mulch
 - Approx. 6' wide
 - Walking Path
 - See striping specifications for all walking paths on existing asphalt and concrete
 - Approx. 6' wide
 - Walking Path
 - See detail for walking path material within landscape areas
 - OPEN
 - Bench
 - Keystone Ridge Designs model # P26
 - Picnic Table
 - Keystone Ridge Designs model # PP6-2RT
 - Trash Can
 - Keystone Ridge Designs model # RE3-32
 - Planting Pot
 - Quick Crete model # xxxxxx
 - Decorative Fountain
 - ¾" Electrical Conduit
 - Circuit # 1 From source to all light/ speaker plasters in picnic area
 - Circuit # 2 From source to all light/ speaker plasters in picnic area
 - Circuit # 3 From source to fountain
 - Circuit # 4 From source to Alumawood trellis
 - Circuit # 5 From source to Alumawood trellis
- Notes:**
- All work shall adhere to local, state, federal and Cal Osha laws and regulations
 - All debris shall be removed from the site and disposed of in a legal manner
 - Contractor is responsible for the procurement of all required permits and licenses

RCB & SONS INC.
 11897 Magnolia Avenue - 92503-4919
 Riverside, CA 92503
 Phone: (951) 689-6377
 Fax: (951) 689-4069
 Web Site: www.rcbandsons.com

Landscape Architect License No. 3345
 Landscape Contractor License No. 349815

DATE: AUGUST 22, 2007

RCB & Sons

LANDSCAPE ARCHITECT
LANDSCAPE CONTRACTOR

DESIGNED: ERIC BARNETT

DATE	REVISION

CONSTRUCTION PLAN

RIVERSIDE COUNTY FLOOD CONTROL AND
 WATER CONSERVATION DISTRICT
 1995 MARKET STREET
 RIVERSIDE, CALIFORNIA 92501

Underground Service Alert

CALL BEFORE YOU DIG

Call: TOLL FREE
 1-800-422-4133

TWO WORKING DAYS BEFORE YOU DIG



SCALE: 1" = 30'-0"

SHEET NO. **7** OF **15**

NORTH

Planting Plan

The planting plan theme involves using California-native plant species and minimizing irrigation needs. The types of plants shown on the plan sheets are examples to demonstrate the variations that are possible. The actual plants and combinations will be selected during early 2008 as the plan is refined. The overall theme will include:

- planting drought-resistant trees and shrubs, particularly in the south corner (front gate, right side as you exit the District) lawn area. This area may also include improved turf to infiltrate parking lot runoff from the site.
- positioning trees to provide shade.
- "flow-through" planters (not shown) near atrium areas in the center, south side of Building 1A to receive roof run-off via a downspout.

Santa Ana River

Market Street

60 Freeway

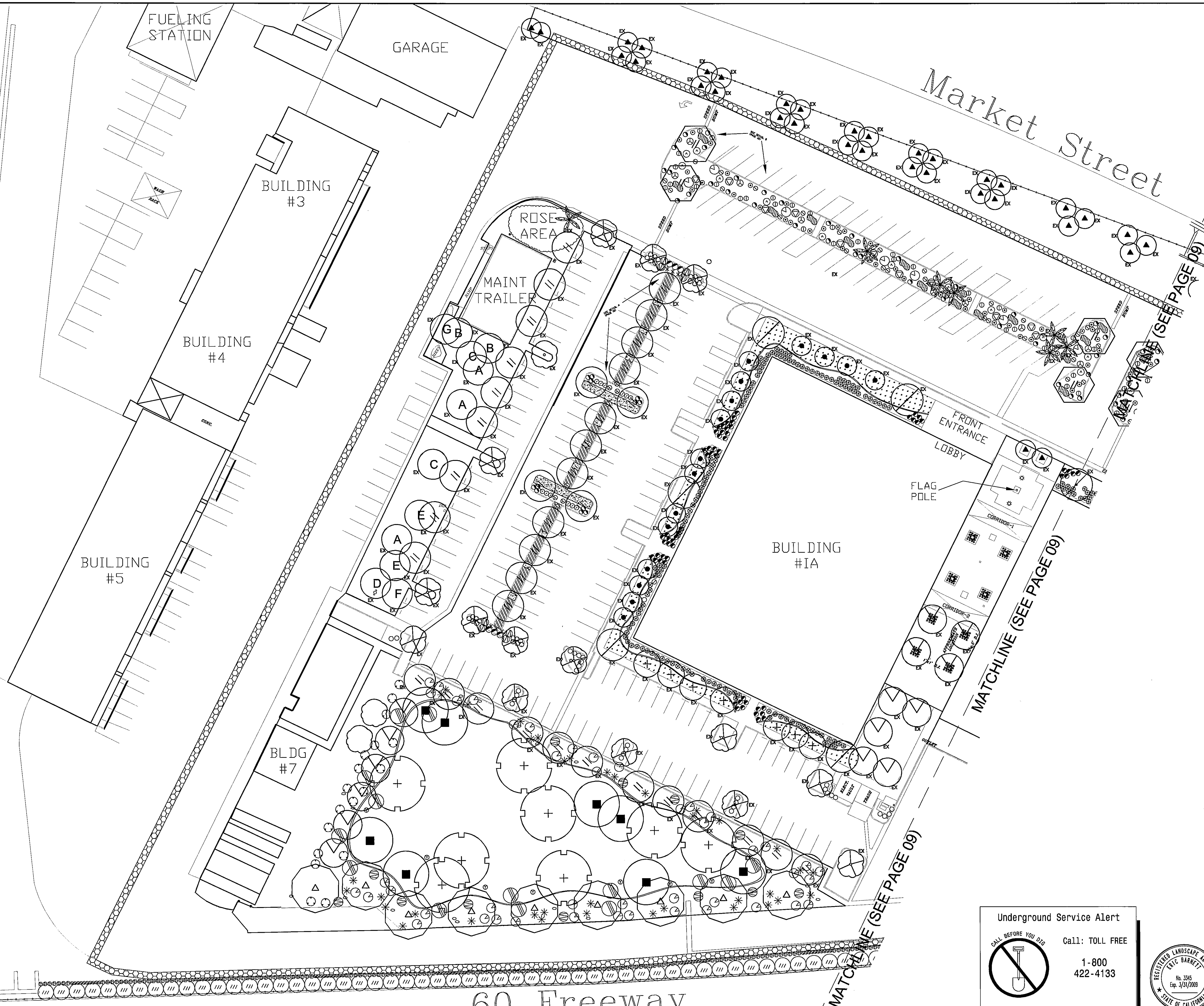

RCB & SONS INC.
 11987 Magnolia Avenue
 Riverside, California 92503-4919
 Phone: (951) 689-0067
 Fax: (951) 689-0069
 Web Site: www.rcbandsons.com
 Landscape Architect License No. 3345
 Landscape Contractor License No. 349815
 DATE: AUGUST 22, 2007

RCB & Sons
 LANDSCAPE ARCHITECT
 LANDSCAPE CONTRACTOR
 DESIGNED: ERIC BARNETT
 DRAWN: S. HART

DATE	REVISION

PLANTING PLAN
 RIVERSIDE COUNTY FLOOD CONTROL AND
 WATER CONSERVATION DISTRICT
 1995 MARKET STREET
 RIVERSIDE, CALIFORNIA 92501

SCALE: 1" = 30'-0"
 SHEET NO. **8**
 OF **15**
 NORTH

Underground Service Alert
 CALL BEFORE YOU DIG
 Call: TOLL FREE
 1-800
 422-4133
 TWO WORKING DAYS BEFORE YOU DIG



RCB & SONS, INC. LANDSCAPE ARCHITECTURE RESERVES ITS COMMON LAW COPYRIGHT TO THE CONTENT AND USE OF THESE DRAWINGS OR PLANS. NO PORTION OF THESE DRAWINGS ARE TO BE REPRODUCED, CHANGED, OR COPIED WITHOUT THE EXPRESS WRITTEN PERMISSION OF RCB & SONS, INC. LANDSCAPING ARCHITECT.

SYMBOL	BOTANICAL NAME	COMMON NAME	SIZE	QTY.
TREES				
○	MORUS	MULBERRY TREE	-	-
○	MELALEUCA LEUCADENDRA	CAJUPUT TREE	-	-
○	CUPANIOPSIS ANACARDIODES	CARROT WOOD	-	-
○	LAGERSTROEMIA INDICA	CREPE MYRTLE 'LAVENDER'	-	-
○	MAGNOLIA GRANDIFLORA	MAJESTIC BEAUTY	-	-
○	MAGNOLIA SOULANGIANA	SAUCER MAGNOLIA	-	-
○	PODOCARPUS GRACILIOR	FERN PINE	-	-
○	PIUNIS CERASOPERA 'ATROPURPARCA'	PURPLE LEAF PLUM	-	-
○	EUCALYPTUS CAMALDULENSIS	RED GUM	-	-
○	WASHINGTONIA ROBUSTA	MEXICAN FAN PALM	-	-
○	FRAXINUS UHDEI	SHAMELASH	-	-
○	MORUS ALBA	FRUITLESS MULBERRY	-	-
○	CUPRESSUS	CYPRESS	-	-
○	CASSIA LEPTOPHYLLA	GOLD MEDALLION TREE	15 GAL.	-
○	AVOCADO	-	-	-
○	CITRUS ORANGE	-	-	-
○	CITRUS LIME	-	-	-
○	PEACH	-	-	-
○	CITRUS LEMON	-	-	-
○	CUPANIOPSIS ANACARDIODES	CARROT WOOD	-	-
○	PYRUS	ORNAMENTAL PEAR STD.	-	-
SHRUBS				
○	AGAPANTHUS AFRICANUS	LILY-OF-THE-NILE	-	-
○	EXCALLONIA	'NEWPORT DWARF'	-	-
○	LIRIOPE MUSCARI	BIG BLUE LILLY TURF	-	-
○	OPHIOPOGON JAPONICUS	MONDO GRASS	-	-
○	PITTIOSPORUM TOBIRA	WHEELERS DWARF	5 GAL.	-
○	RAPHIOLEPIS BALLERINA	INDIAN HAWTHORN	-	-
○	BOUGAINVILLEA	-	-	-
○	CLIMBING ROSES	-	-	-
GROUNDCOVERS				
○	MARATHON	TALL FESCUE TURF	-	-
○	FENCE LINE	-	-	-

SYMBOL	BOTANICAL NAME	COMMON NAME	SIZE	QTY.
GROUNDCOVERS				
○	FESTUCA OVINA GLAUCA 'BLAUSILBER'	BLUE SILVER FESCUE	FLAT	-
○	SEDUM RUBROTINCTUM	PORK AND BEANS	FLAT	-
○	VERBENA PERUVIANA 'PURPLE'	N.C.N.	-	-
○	ROSMARINUS OFFICINALIS	ROSEMARY	1 GAL.	-
○	MYOPORUM PARVIFOLIUM	N.C.N.	-	-
○	TRACHELOSPERMUM JASMINOIDES	STAR JASMINE	1 GAL. 18" O.C.	-
○	ROSE 'FLOWER CARPET'	N.C.N.	1 GAL.	-
○	GRAVEL	-	-	-
○	PHORMIUM TENAX 'JACK SPRATT'	NEW ZEALAND FLAX	1 GAL. 12" O.C.	-
○	CALYLOPHUS DRUMMONDIANUS	SUNDROPS	1 GAL.	-
○	ECHVEERIA AGAVOIDES	N.C.N.	1 GAL. 12" O.C.	-
○	BOULDER	-	-	-

SYMBOL	BOTANICAL NAME	COMMON NAME	SIZE	QTY.
TREES				
○	GINKGO BILOBA	MAIDENHAIR TREE	24" BOX	7
○	PYRUS CALLERYANA 'BRADFORD'	ORNAMENTAL PEAR	24" BOX	6
○	-	-	-	6
○	-	-	-	5
○	ARBITUS UNEDO	STRAWBERRY TREE	24" BOX	19
○	KOELREUTERIA PANICULATA	GOLDENRAIN TREE	24" BOX	7
○	ALBIZIA JULIBRISIN	SILK TREE	24" BOX	1
○	UMBELLULARIA CALIFORNICA	CALIFORNIA BAY TREE	15 GAL.	8
○	LAGERSTROEMIA INDICA 'CHEROKEE'	CRAPE MYRTLE	24" BOX	-
○	LAGERSTROEMIA HYBRID 'WATCHEZ'	CRAPE MYRTLE	24" BOX	3
○	CITRUS-LEMON	LEMON	15 GAL.	-
○	CITRUS-NAVAL	ORANGE	15 GAL.	-
○	CITRUS-VALENCIA	ORANGE	15 GAL.	-
○	CERCIDIUM CANADENSIS 'FOREST PANSY'	EASTERN REDBUD	24" BOX	-
○	LIQUIDAMBAR STYRACIFLUA 'PALO ALTO'	AMERICAN SWEET GUM	15 GAL.	-
○	CALLISTEMON VIMINALIS	WEeping BOTTLEBRUSH	15 GAL.	-
○	QUERCUS LOBATA	VALLEY OAK	15 GAL.	-
○	CASSIA LEPTOPHYLLA	GOLD MEDALLION TREE	24" BOX	-
○	MELALEUCA LEUCADENDRA	CAJUPUT TREE	-	6
○	CUPANIOPSIS ANACARDIODES	CARROT WOOD	-	9
○	PLATANUS RACEMOSA	CALIFORNIA SYCAMORE	15 GAL.	8
○	LAGERSTROEMIA INDICA	CREPE MYRTLE 'LAVENDER'	-	9

SYMBOL	BOTANICAL NAME	COMMON NAME	SIZE	QTY.
SHRUB				
○	VIURNUM TINUS 'SPRING BOUQUET' ('COMPACTUM')	LAURUSTINUS	5 GAL.	-
○	NANDINA DOMESTICA 'HARBOR DWARF'	HEAVENLY BAMBOO, SACRED BAMBOO	5 GAL.	-
○	CALLIANDRA HAMATOCEPHALA	PINK POWDER PUFF	5 GAL.	-
○	SALVIA LEUCOPHYLLA	PURPLE SAGE, GRAY SAGE	1 GAL.	-
○	SALVIA GREGGII	AUTUMN SAGE	5 GAL.	25
○	SALVIA MELLIFERA	BLACK SAGE, HONEY SAGE	5 GAL.	9
○	CISTUS PURPUREUS	ROCKROSE	1 GAL.	7
○	AGAVE AMERICANA 'VARIGATED'	CENTURY PLANT	5 GAL.	8
○	AGAVE ATTENUATA	N.C.N.	5 GAL.	-
○	AGAVE STRIATA	N.C.N.	5 GAL.	-
○	PENTSTEMON SPECTABILIS	ROYAL BEARD TONGUE	1 GAL.	6
○	PHORMIUM TENAX	NEW ZEALAND FLAX	5 GAL.	-
○	PHORMIUM TENAX 'RUBRUM'	NEW ZEALAND FLAX	5 GAL.	-
○	PHORMIUM HYBRIDS 'MAORI MADEN'	NEW ZEALAND FLAX	5 GAL.	7
○	HESPERALOE PARVIFLORA	RED YUCCA	5 GAL.	7
○	ACHILLEA TOMENTOSA	WOOLLY YARROW	1 GAL.	-
○	ARTEMISIA 'POWIS CASTLE'	N.C.N.	1 GAL.	-
○	GALLARDIA X GRANDIFLORA 'GOBLIN'	BLANKET FLOWER	1 GAL.	-
○	ARTEMISIA 'POWIS CASTLE'	N.C.N.	1 GAL.	-
○	LAVANDULA DENTATA	FRENCH LAVENDER, TOOTHED LAVENDER	5 GAL.	-
○	ELDONYMUS	N.C.N.	5 GAL.	-
○	LANTANA MONTEVIDENSIS	N.C.N.	1 GAL.	-
○	LANTANA HYBRIDS 'SPREADING SUNSHINE'	N.C.N.	1 GAL.	-
○	MUHLENBERGIA CAPILLARIS	PINK MUHLY	1 GAL. 68	-
○	MUHLENBERGIA RIGENS	DEER GRASS	1 GAL.	-
○	ECHIUM CANDICANS (E. FASTUOSUM)	PRIDE OF MADIRA	5 GAL.	3
○	HEMEROCALLIS SPP. 'SALMON'	SALMON DAYLILY	1 GAL.	-
○	HEMEROCALLIS HYBRIDS 'STELLA DE ORO'	DAYLILY	1 GAL.	-
○	AGUILEGA	COLUMBINE	1 GAL.	-
○	ALOE	ALOE	5 GAL.	-
○	ALOE ARBORESCENS	TREE ALOE	-	38
○	PENNISETUM SETACEUM 'RUBRUM'	FOUNTAIN GRASS	-	44
○	ERIGERON KARVINSKIANUS	MEXICAN DAISY, SANTA BARBARA DAISY	1 GAL.	34
○	BUDDLEIA	BUTTERFLY BUSH	5 GAL.	10
○	PITTIOSPORUM VARIGATA	MOCK ORANGE	5 GAL.	-
○	PITTIOSPORUM TOBIRA	MOCK ORANGE	5 GAL.	-
○	ROSA 'ICEBERG'	ROSE	5 GAL.	18
○	ROSA RUGOSA	RAMANAS ROSE, SEA TOMATO	5 GAL.	18
○	HETEROMELES ARBUTIFOLIA	TOYON	5 GAL.	-
○	PYRACANTHA KOIDZUMI 'SANTA CRUZ'	FIRE THORN	5 GAL.	22
○	ECHVEERIA	N.C.N.	1 GAL.	-
○	STACHYS BYZANTINA	LAMB'S EARS	1 GAL.	-
○	COTINUS COGKYGRIA 'ROYAL PURPLE'	SMOKE TREE	5 GAL.	8
○	SALVIA OFFICINALIS 'TRICOLOR'	GARDEN SAGE, COMMON SAGE	1 GAL.	13
○	LEONOTIS LEONURUS	LION'S TAIL	5 GAL.	7
○	CALLISTEMON VIMINALIS 'LITTLE JOHN'	WEeping BOTTLEBRUSH	3" O.C. 5 GAL.	279
○	GAURA LINDHEIMERI	WAND FLOWERS	3" O.C. 1 GAL.	140
○	-	-	-	5
○	XYLOSMA CONGESTUM	SHINY CONGESTUM	-	108
○	ALOE STRIATA	CORAL ALOE	5 GAL.	-
○	-	-	-	4
○	-	-	-	-
○	-	-	-	-
○	ROMNEYA COULTERI	MATILJA POPPY	-	13
○	CASSIA ARTEMISIODIDES	FEATHERY CASSIA	-	12
○	DIETES IRIODIDES	FORTNIGHT LILY, ARICAN IRIS	5 GAL.	-
○	GERANIUM 'JOHNSON BLUE'	-	-	-

- PLANTING NOTES**
1. ALL SHrub AREAS TO RECEIVE 5" CIRCLES "WALK ON DARK MILK" FROM EARTH WORKS, RIVERSIDE, CALIFORNIA (951) 787-0760.
 2. ALL TREES TO BE SEPARATED FROM SHrub AREAS WITH 6"x6" CONCRETE MOUNTED WITH #4 REBAR.
 3. PLANTING LEGENDS AND IRRIGATION LEGENDS DO NOT HAVE INTERCHANGEABLE SYMBOLS.
 4. EXISTING TREES TO BE SPRAWN 2 TIMES NON SELECTIVE SYSTEMS BY A CERTIFIED PESTICIDE APPLICATOR.
 5. ALL ROUGH GRADING SHALL BE COMPLETED PRIOR TO IRRIGATION, PLANTING, & CONSTRUCTION WORK. OWNER SHALL COMPLY WITH ALL STATE, LOCAL, & FEDERAL REGULATIONS.
 6. GROUNDCOVERS SYMBOLS ARE DRAWN FOR LEGIBILITY. ALL GROUNDCOVERS SHALL EXTEND IN AND UNDER SHrubS AND TREES.

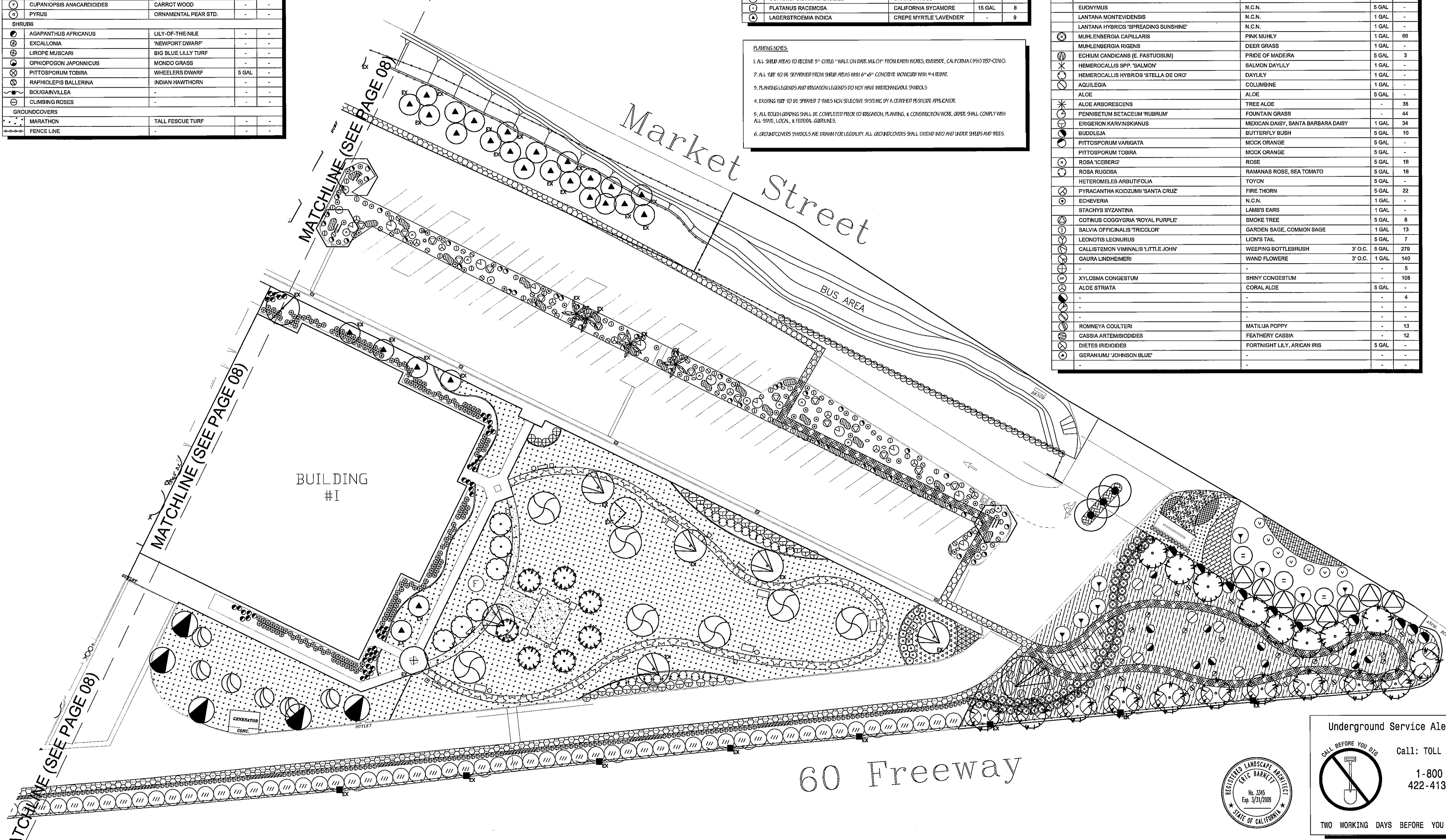

RCB & SONS INC.

11997 Magnolia Avenue,
Riverside, California 92503-4919
Voice: (951) 889-6877
Fax: (951) 889-6888
Web Site: www.rcbsonsonline.com

Landscape Architect
License No. 3345
License No. 349815

DATE: AUGUST 22, 2007

RCB & Sons

LANDSCAPE ARCHITECT
LANDSCAPE CONTRACTOR

DESIGNED: ERIC BARNETT

DRAWN: S. HART

DATE	REVISION

PLANTING PLAN

RIVERSIDE COUNTY FLOOD CONTROL AND
WATER CONSERVATION DISTRICT
1995 MARKET STREET
RIVERSIDE, CALIFORNIA 92501

SCALE: 1" = 30'-0"

SHEET NO.

9

OF

15



Underground Service Alert

CALL BEFORE YOU DIG

Call: TOLL FREE
1-800-422-4133

TWO WORKING DAYS BEFORE YOU DIG

